

For Lease - Central Visalia Office Space \$3,200/Month

Open Reception & Break Area, 6 Private Offices, 3 Restrooms

2380 W. Whitendale Ave. Visalia, CA 93277



FOR LEASE • 2,662 SF OFFICE SPACE

MARC GRIFFITHS | ZEEB COMMERCIAL BROKER ASSOCIATE
DRE# 01434697 - 559.625.2128 x12 - marc@zeebre.com

ZEEB

Commercial Real Estate

Visalia's Most Respected Commercial Real Estate Firm
132 N. Akers St., Visalia, CA 93291 • (559) 625-2128

LISTING HIGHLIGHTS

Central Visalia Office Available for Lease. Great location, just off Mooney Blvd. in the Whitendale Professional Office Complex. Space includes open reception area, 6 private offices, 3 restrooms and break area.



FOR LEASE 2,662 OFFICE SPACE

2380 W. Whitendale Ave. Visalia, CA 93277

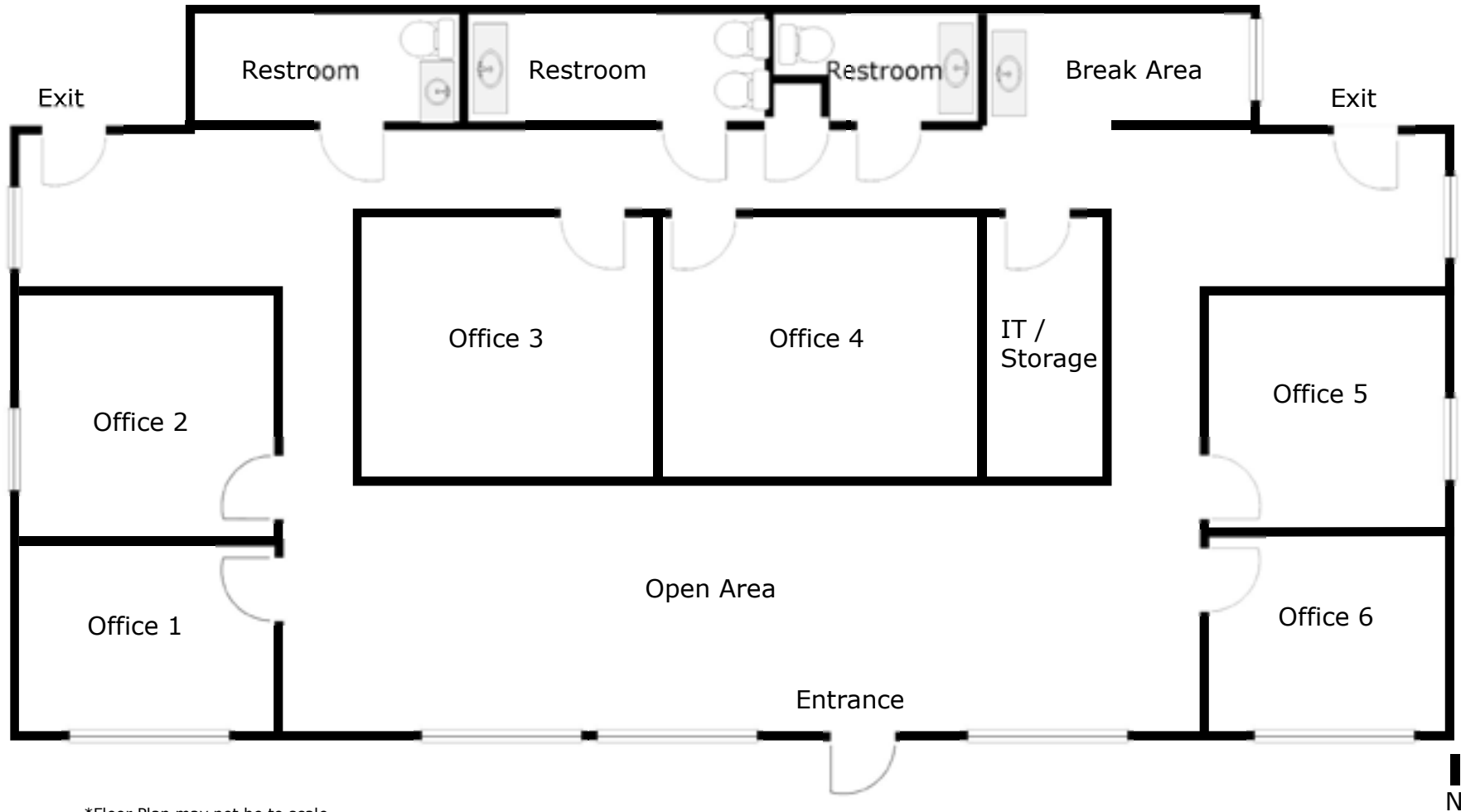

DEMOGRAPHICS

POPULATION

	1 Mile	3 Mile	5 Mile
2018 TOTAL POPULATION	10,587	72,322	131,771
Average Age	26.1	30.9	31.8
Average Age (Male)	25.6	30.3	31.0
Average Age (Female)	27.2	32.6	33.5

HOUSEHOLDS

	1 Mile	3 Mile	5 Mile
Total Households	2,906	22,900	43,502
# of Persons per HH	3.6	3.2	3.0
Average HH Income	\$48,244	\$64,358	\$66,694
Average House Value	\$177,045	\$263,934	\$276,893

FOR LEASE 2,662 OFFICE SPACE 2380 W. Whitendale Ave. Visalia, CA 93277

