

AVAILABLE FOR LEASE  
MULTI-TENANT OFFICE BUILDING

227 & 229 N. WEST STREET  
VISALIA, CA

*For information, please contact:*

**Mike Porte**

*Newmark Pearson Commercial*  
m 559-972-2421  
mporte@pearsonrealty.com  
CA RE Lic. #01075873

**John Akers**

*Zeeb Commercial Real Estate*  
t 559 625-2128  
john@zeebre.com  
CA RE Lic. #00871521

**NEWMARK**  
PEARSON COMMERCIAL

**ZEEB**  
COMMERCIAL REAL ESTATE

*Independently Owned and Operated* | Corporate License #00020875 | [newmarkpearson.com](http://newmarkpearson.com) | [zeebre.com](http://zeebre.com)

**VISALIA OFFICE:** 3447 S. Demaree St., Visalia, CA 93277, t 559-732-7300

The distributor of this communication is performing acts for which a real estate license is required. The information contained herein has been obtained from sources deemed reliable but has not been verified and no guarantee, warranty or representation, either express or implied, is made with respect to such information. Terms of sale or lease and availability are subject to change or withdrawal without notice.

**227 & 229 N. WEST STREET**  
VISALIA, CA

**PROPERTY**  
DESCRIPTION

Multi-Tenant office building with two suites, 2,503± square feet and 1,037± square feet. The larger space has reception, 4 private offices, large bull pin with cubicles in place available for additional fee. Also there is a large printer that may also be available. The 1,037± square foot space is leased to American Ambulance on a month-to-month basis and is available for a long term tenant. On-site fenced parking with 14 stalls.



# 227 & 229 N. WEST STREET

VISALIA, CA

## PROPERTY INFORMATION

<b>Availability:</b>	Two Suites
<i>227 N. West Street:</i>	<i>2,503± SF</i>
<i>229 N. West Street:</i>	<i>1,037± SF</i>
<b>Lot Size:</b>	8,712± SF
<b>Tenancy:</b>	Multiple
<b>Property Subtype:</b>	Office Building
<b>Ceiling Height:</b>	10'
<b>Building Class:</b>	B
<b>Parking Ratio:</b>	14 Stalls
<b>Year Built:</b>	1970
<b>Zoning:</b>	D-MU ( <i>Downtown Mixed Use</i> )
<b>APN:</b>	093-185-003 ( <i>Tulare County</i> )

### HIGHLIGHTS

- Free Standing Building
- Secured Fenced Parking Lot
- Full Build-Out
- In Place Cubicles
- Kitchen
- Downtown District
- Close to Kaweah Health Medical Center
- Quick access to Highway 198



**\$1.50 PSF**  
LEASE RATE

**Gross**  
LEASE TYPE

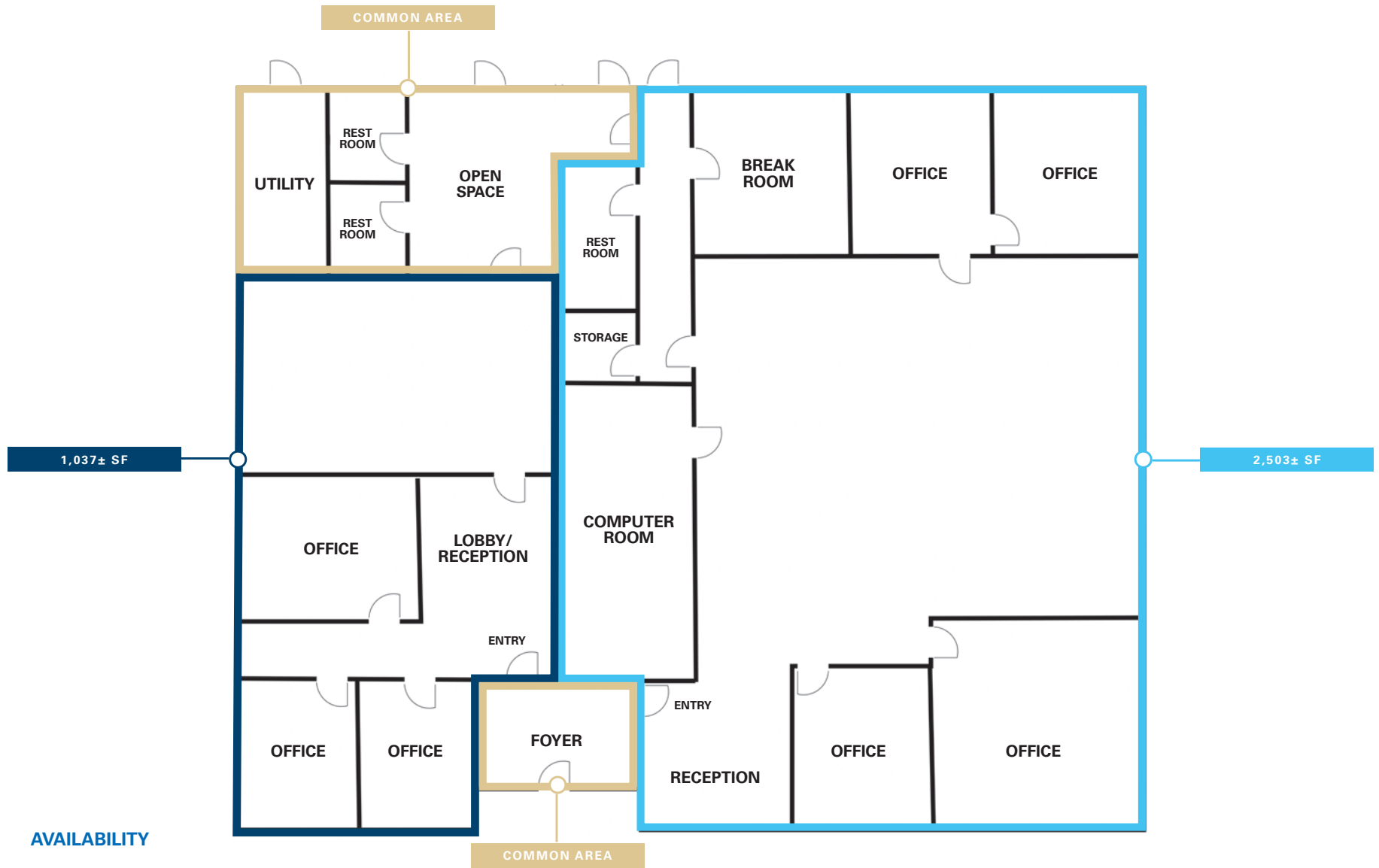

**AVAILABILITY**

- 229 N. West Street - 1,037± SF
- 227 N. West Street - 2,503± SF



**227 & 229 N. WEST STREET**  
VISALIA, CA

**INTERIOR**  
IMAGES



**227 & 229 N. WEST STREET**  
VISALIA, CA

**PROPERTY**  
IMAGES



**227 & 229 N. WEST STREET**  
VISALIA, CA

**AERIAL**  
MAP



AVAILABLE FOR LEASE  
MULTI-TENANT OFFICE BUILDING

227 & 229 N. WEST STREET  
VISALIA, CA

*For information, please contact:*

**Mike Porte**

*Newmark Pearson Commercial*

t 559-972-2421

mporte@pearsonrealty.com

CA RE Lic. #01075873

**John Akers**

*Zeeb Commercial Real Estate*

t 559 625-2128

jakers@pearsonrealty.com

CA RE Lic. #00871521

**NEWMARK**  
PEARSON COMMERCIAL

**ZEEB**  
COMMERCIAL REAL ESTATE

*Independently Owned and Operated* | Corporate License #00020875 | [newmarkpearson.com](http://newmarkpearson.com) | [zeebre.com](http://zeebre.com)

**VISALIA OFFICE:** 3447 S. Demaree St., Visalia, CA 93277, t 559-732-7300

The distributor of this communication is performing acts for which a real estate license is required. The information contained herein has been obtained from sources deemed reliable but has not been verified and no guarantee, warranty or representation, either express or implied, is made with respect to such information. Terms of sale or lease and availability are subject to change or withdrawal without notice.