

AVAILABLE FOR LEASE

1,500± SF | SUITE D

2340 E VALLEY OAKS

VISALIA, CA



MARC GRIFFITHS
SENIOR VICE PRESIDENT
T 559-625-2128
MARC@ZEEBRE.COM
CA RE LIC. #01434697

Independently Owned and Operated | Corporate License #00020875 | zeebre.com

OFFICE: 3447 S. Demaree St., Visalia, CA 93277, t 559-732-7300

The distributor of this communication is performing acts for which a real estate license is required. The information contained herein has been obtained from sources deemed reliable but has not been verified and no guarantee, warranty or representation, either express or implied, is made with respect to such information. Terms of sale or lease and availability are subject to change or withdrawal without notice.

PROPERTY DESCRIPTION

Clean shop space for lease. Includes two (2) roll up doors, small office and shared restrooms

Availability Warehouse Space: Office Space:	Suite D 1,500± SF 1,350± SF 150± SF
Lot Size:	39,532± Acres
Tenancy:	Multi Tenant
Property Subtype:	Service Commercial
Ceiling Height:	14'
Grade Level Doors:	Two
Drive in Bays:	Two
Parking:	On-Site
Zoning:	C-S (<i>Service Commercial</i>)
APN:	098-103-012 (<i>Tulare County</i>)



\$1,125.00 (MONTHLY)
LEASE RATE

INDUSTRIAL

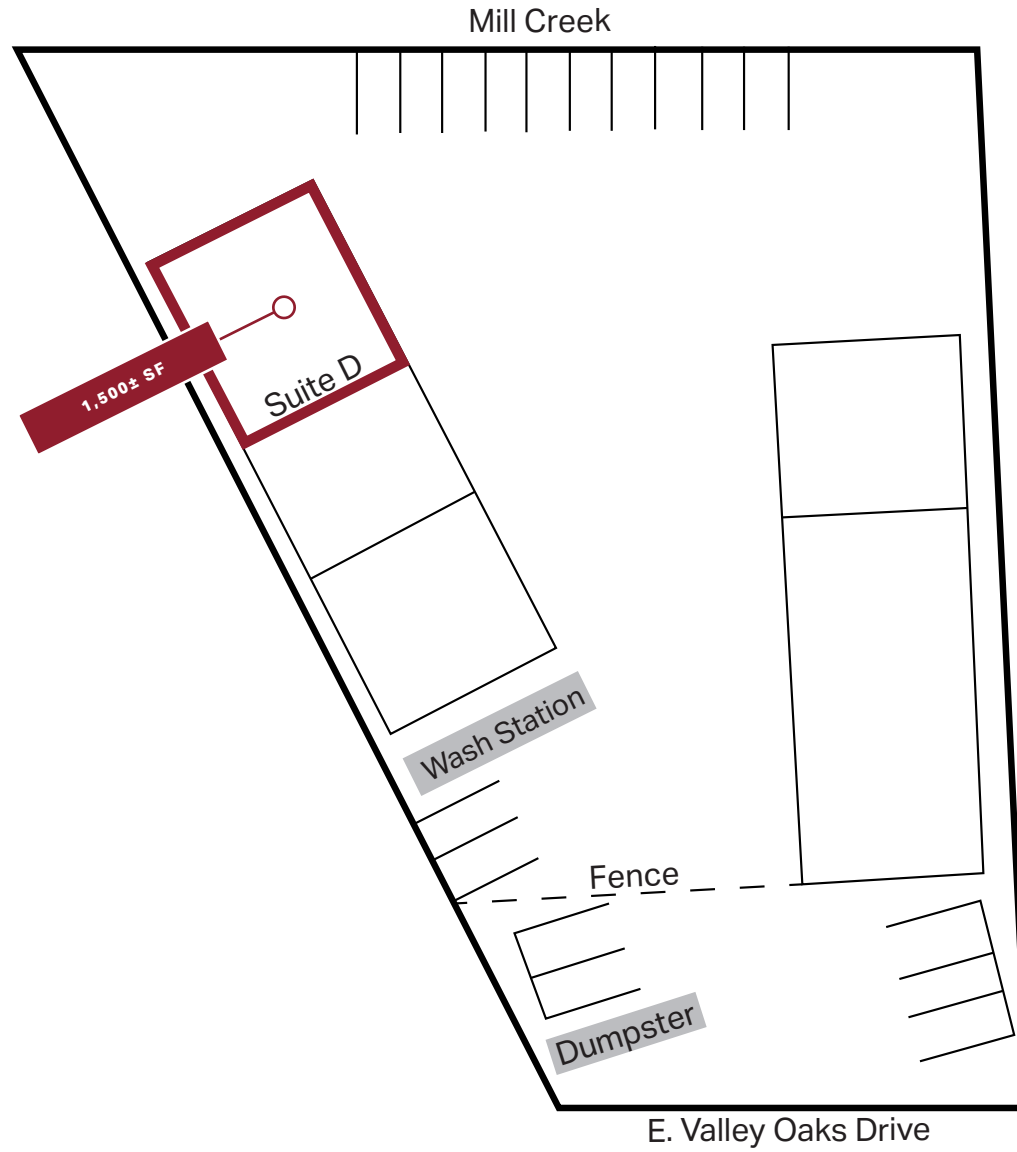



For information, please contact:

Marc Griffiths
Senior Vice President
t 559-625-2128
marc@zeebre.com
CA RE Lic. #01434697



Independently Owned and Operated | Corporate License #00020875 | zeebre.com
OFFICE: 3447 S. Demaree St., Visalia, CA 93277, t 559-732-7300
The distributor of this communication is performing acts for which a real estate license is required. The information contained herein has been obtained from sources deemed reliable but has not been verified and no guarantee, warranty or representation, either express or implied, is made with respect to such information. Terms of sale or lease and availability are subject to change or withdrawal without notice.