

AVAILABLE FOR LEASE
2,630± SF OFFICE BUILDING

1433 E. EL MONTE WAY
DINUBA, CA



For information, please contact:

JOHN AKERS
ZEEB COMMERCIAL REAL ESTATE
t 559-625-2128
john@zeebre.com
CA RE Lic. #00871521

MICHAEL R. PORTE, SIOR
NEWMARK PEARSON COMMERCIAL
t 559-972-2421
mporte@pearsonrealty.com
CA RE Lic. #01075873

ZEEB
COMMERCIAL REAL ESTATE

NEWMARK
PEARSON COMMERCIAL

Independently Owned and Operated | Corporate License #00020875 | zeebre.com | newmarkpearson.com

OFFICE: 3447 S. Demaree St., Visalia, CA 93277, t 559-625-2128

The distributor of this communication is performing acts for which a real estate license is required. The information contained herein has been obtained from sources deemed reliable but has not been verified and no guarantee, warranty or representation, either express or implied, is made with respect to such information. Terms of sale or lease and availability are subject to change or withdrawal without notice.

1433 E. EL MONTE WAY
DINUBA, CA

AVAILABLE FOR LEASE
OFFICE BUILDING

Building Size: 2,630± SF
Cross Streets: Palm Drive
Property Type: Professional Office Building
Year Built: 1982
Zoning: PO (*Professional Office*)
APN: 014-243-014 (*Tulare County*)

PROPERTY DESCRIPTION

Free standing Professional Office Building in office park with onsite parking. Central location in Dinuba to serve clients from Dinuba and rural adjacent areas. Short distance from downtown and nearby shopping centers. Most recently used as a medical office. Building includes 5 private offices, large bull pen area with nice modular partitions creating more work stations. Also includes two front doors to provide multiple services offered from one suite.

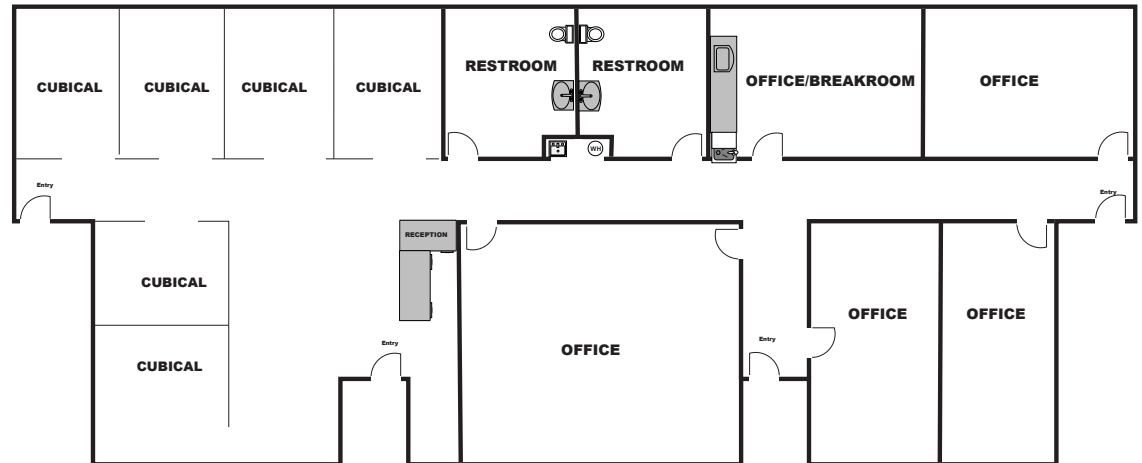

\$3,698
MONTHLY

Gross
LEASE RATE



1433 E. EL MONTE WAY
DINUBA, CA

PROPERTY
INTERIOR PHOTOS





For information, please contact:

JOHN AKERS
ZEEB COMMERCIAL REAL ESTATE
T 559-625-2128
JOHN@ZEEBRE.COM
CA RE Lic. #00871521

MICHAEL R. PORTE, SIOR
NEWMARK PEARSON COMMERCIAL
T 559-972-2421
MPORTE@PEARSONREALTY.COM
CA RE Lic. #01075873

ZEEB
COMMERCIAL REAL ESTATE

NEWMARK
PEARSON COMMERCIAL

Independently Owned and Operated | Corporate License #00020875 | zeebre.com | newmarkpearson.com
OFFICE: 3447 S. Demaree St., Visalia, CA 93277, t 559-625-2128

The distributor of this communication is performing acts for which a real estate license is required. The information contained herein has been obtained from sources deemed reliable but has not been verified and no guarantee, warranty or representation, either express or implied, is made with respect to such information. Terms of sale or lease and availability are subject to change or withdrawal without notice.