

AVAILABLE FOR LEASE
2,410± SF OFFICE SPACE

1384-1386 E. TULARE AVENUE
TULARE, CA

For information, please contact:

Mike Porte

Newmark Pearson Commercial

t 559-302-1911

mporte@pearsonrealty.com

CA RE Lic. #01075873

John Akers

Zeeb Pearson Commercial

t 559-625-2128

john@zeebre.com

CA RE Lic. #00871521

NEWMARK
PEARSON COMMERCIAL

ZEEB
PEARSON COMMERCIAL

Independently Owned and Operated | Corporate License #00020875 | newmarkpearson.com | zeebre.com

FRESNO OFFICE: 7480 N. Palm Ave. #101, Fresno, CA 93711, t 559-432-6200 | **VISALIA OFFICE:** 3447 S. Demaree St., Visalia, CA 93277, t 559-732-7300

The distributor of this communication is performing acts for which a real estate license is required. The information contained herein has been obtained from sources deemed reliable but has not been verified and no guarantee, warranty or representation, either express or implied, is made with respect to such information. Terms of sale or lease and availability are subject to change or withdrawal without notice.

1384-1386 E. TULARE AVENUE
TULARE, CA

PROPERTY
INFORMATION

Availability: 2,410± SF
Tenancy: Single
Year Built: 2010
Zoning: C-4 (*Service Commercial*)
APN: 171-080-055 (*Tulare County*)

PROPERTY DESCRIPTION

Centrally located office building with 8 private offices. Easy access to highway 99.

HIGHLIGHTS

- 8 Private Offices
- Large Conference Room
- Breakroom
- Reception Area
- 3 Private Restrooms
- Quick Access To Highway 99
- \$1.30/SF | 2,410± SF



\$3,133.00 (Monthly)
ASKING RENT

Modified Gross
SUB/LEASE TYPE

1384-1386 E. TULARE AVENUE
TULARE, CA

INTERIOR
PHOTOS



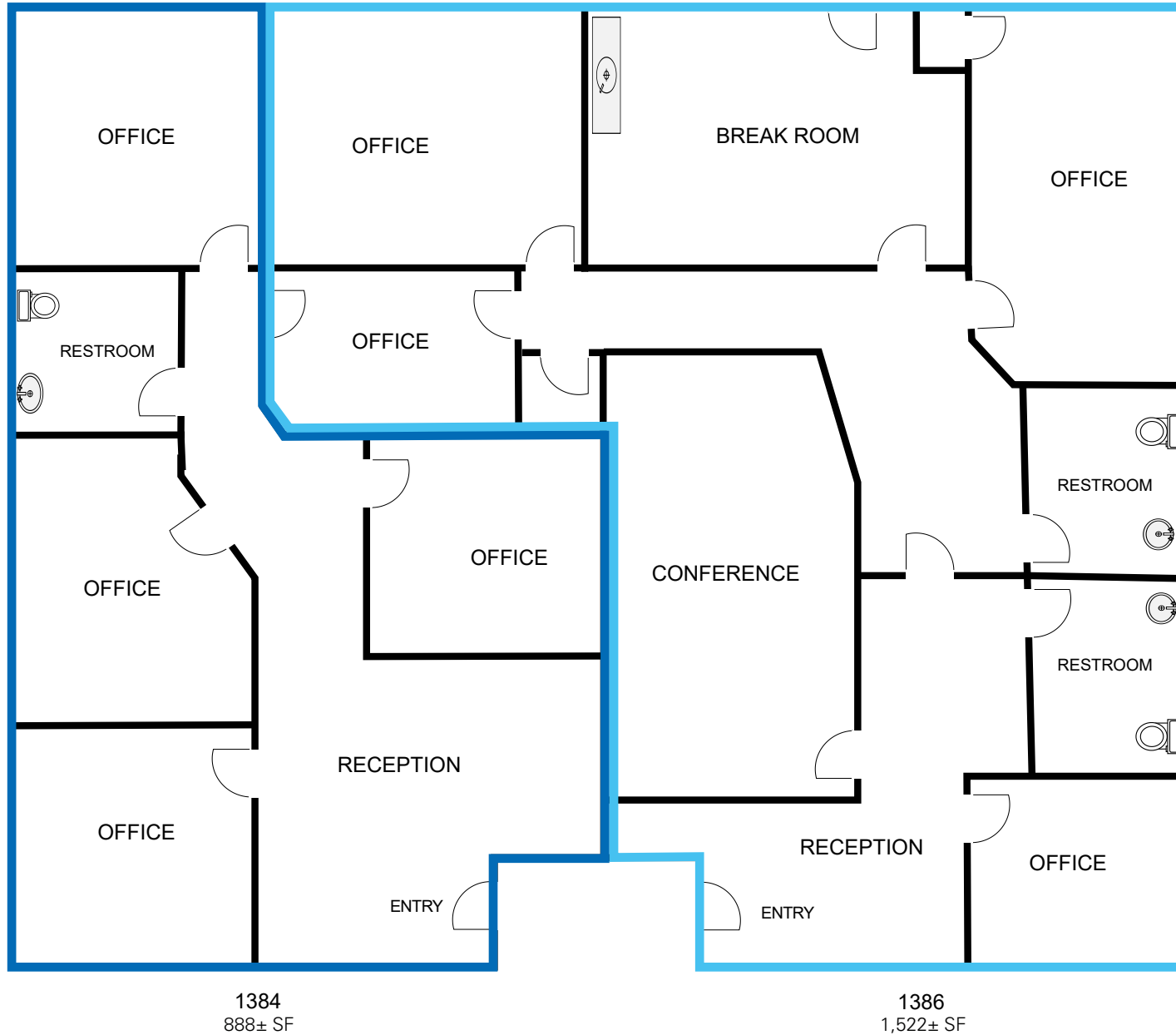

1384-1386 E. TULARE AVENUE
TULARE, CA

AERIAL
MAP

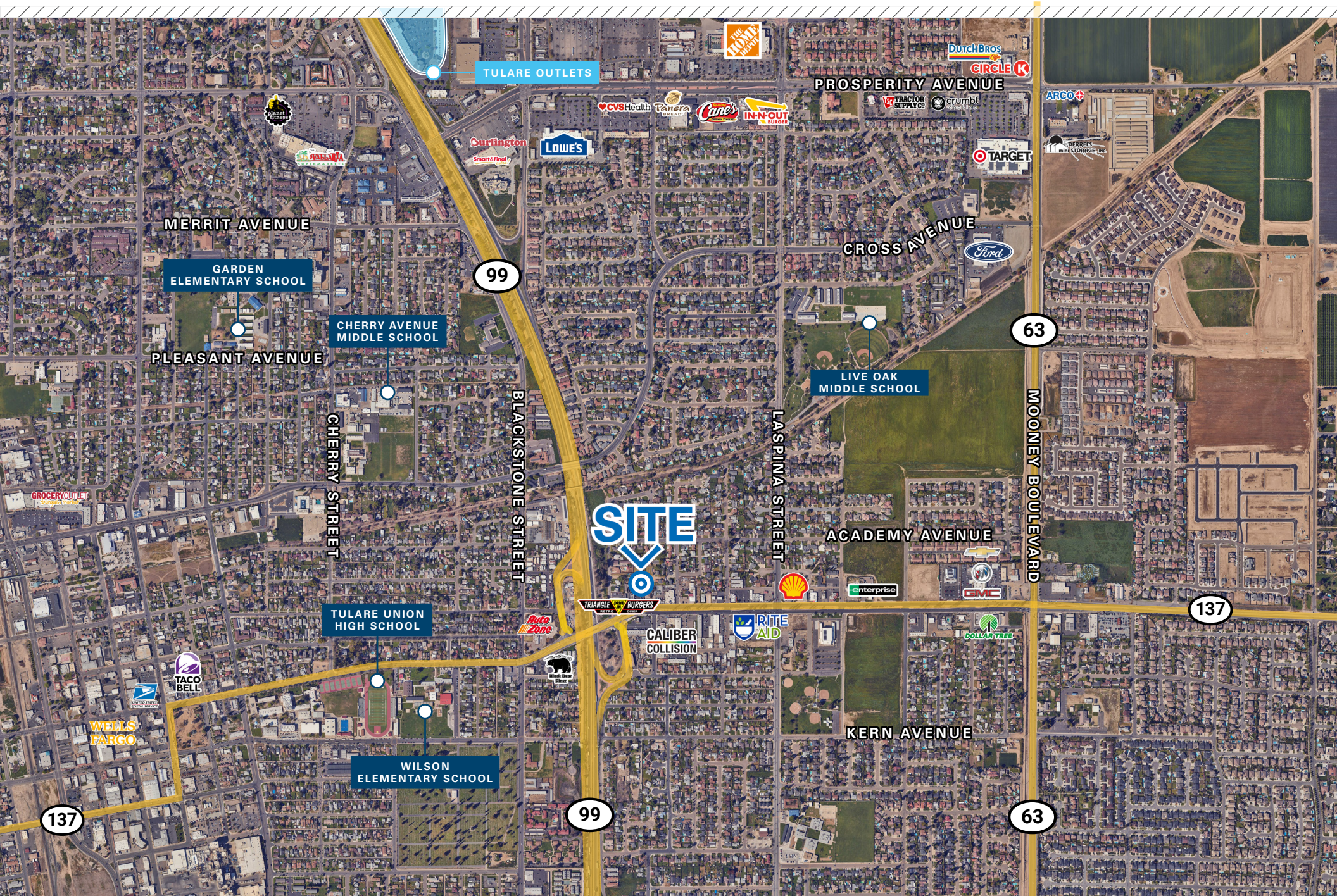

AVAILABLE FOR LEASE
2,410± SF OFFICE SPACE

1384-1386 E. TULARE AVENUE
TULARE, CA

For information, please contact:

Mike Porte

Newmark Pearson Commercial
t 559-302-1911
mporte@pearsonrealty.com
CA RE Lic. #01075873

John Akers

Zeeb Pearson Commercial
t 559-625-2128
john@zeebre.com
CA RE Lic. #00871521

NEWMARK
PEARSON COMMERCIAL

ZEEB
PEARSON COMMERCIAL

Independently Owned and Operated | Corporate License #00020875 | newmarkpearson.com | zeebre.com

FRESNO OFFICE: 7480 N. Palm Ave. #101, Fresno, CA 93711, t 559-432-6200 | **VISALIA OFFICE:** 3447 S. Demaree St., Visalia, CA 93277, t 559-732-7300
The distributor of this communication is performing acts for which a real estate license is required. The information contained herein has been obtained from sources deemed reliable but has not been verified and no guarantee, warranty or representation, either express or implied, is made with respect to such information. Terms of sale or lease and availability are subject to change or withdrawal without notice.